

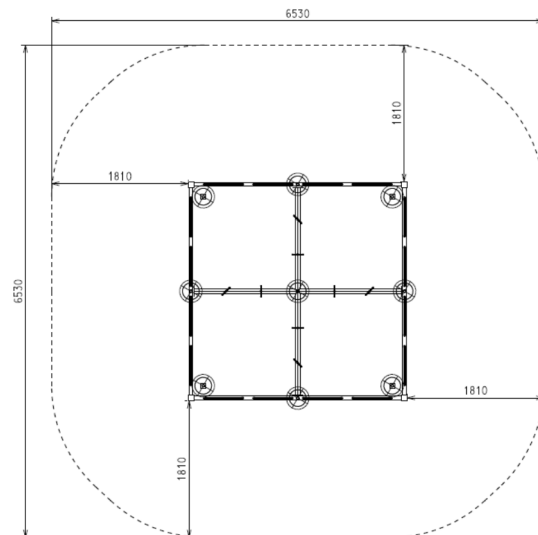

TARZAN MAZE

SPECIFICATION SHEET

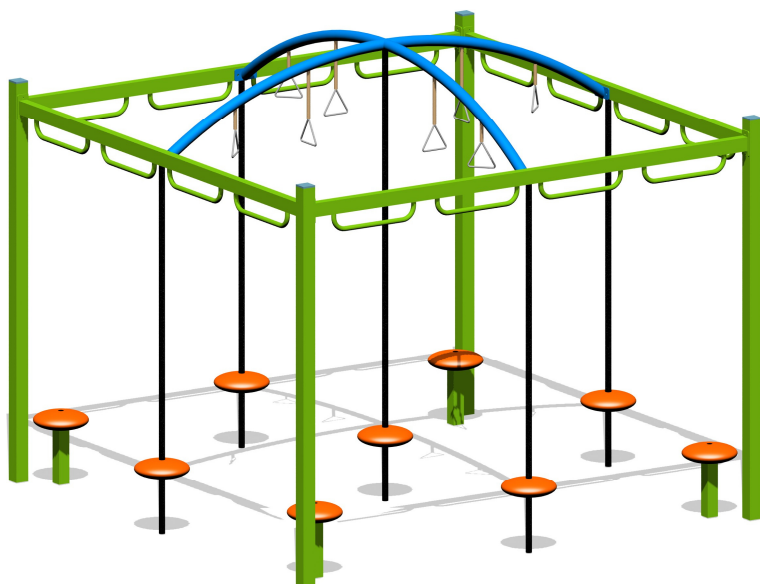

FALL ZONES

Area: 6.53m x 6.53m (38.9m²) | FHOF: 2.0m | Equip Size: 3.14m x 3.14m | Max Height: 2.55m

PRODUCT CODE	FS20
COLOURS	Frame: Standard powder coat range Rope: Standard rope range Pommels: Standard plastic range
MATERIAL SPECIFICATION	Frame: Galvanised steel Fasteners: Steel & stainless steel Chains: Galvanised steel Powder Coating: 80-120µ Plastic: Roto moulded
AGE GROUP	6-12 years
PLAYSPACES	Parks, schools, commercial



[DOWNLOAD DESIGN FILES HERE](#)



OTHER INFORMATION

Spare Parts: Available | Warranty: 20 years | Quality Assurance: Yes | Insurance: Yes
Installation: Refer manual

STANDARDS

Complies with relevant Australian Standards including:
• AS 4685:2014 (P 1-6) | • AS 4685.0:2017 | • AS/NZS 4422:2016

*All information is commercial in confidence and is the property of Forpark Australia. All information is correct as at September 2017.

*For details regarding Australian Standards, Warranties, Insurances, QA and Installation please contact your local office.

www.forparkaust.com.au

